



**BISAGRAS PEQUEÑAS CON UNA ALA
ACODADA Y PASADOR EXTRAÍBLE DE 38
MM**

60-1-3331

Pasador extraíble.

A	38 mm
---	-------

Material	acero
Peso (g)	31 g
B	19 mm
C	1.5 mm
S (diamètre trou)	4 mm
E	17 mm
D	3
F	8 mm
G	23 mm
H	26 mm
Acabado	Cromado
Material del husillo	Acero niquelado
J	7 mm

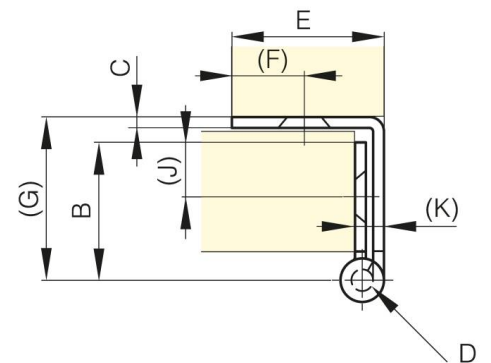
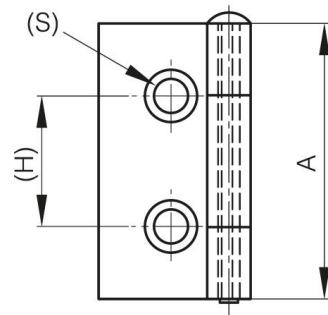
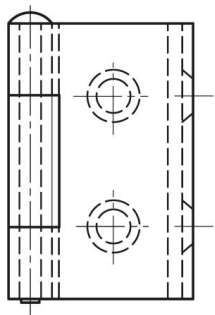

K	3.5 mm
----------	--------