

SPRINGLOADED BOLT - REVERSIBLE BOLT

16-7-3835

Slam bolt - reversible.

Bolt can be manually unassembled to be positioned 'nose-up' or 'nose-down'.

Minimum load 50 N for full bolt travel.

| | |
|-------------------|----------------------------|
| A (length) | 63.2 mm |
| Note | bolt delivered 'nose-down' |

| | |
|-------------------|---------------------|
| Material | 304 stainless steel |
| Weight (g) | 185 g |
| B (width) | 57 mm |
| C | 17.2 mm |

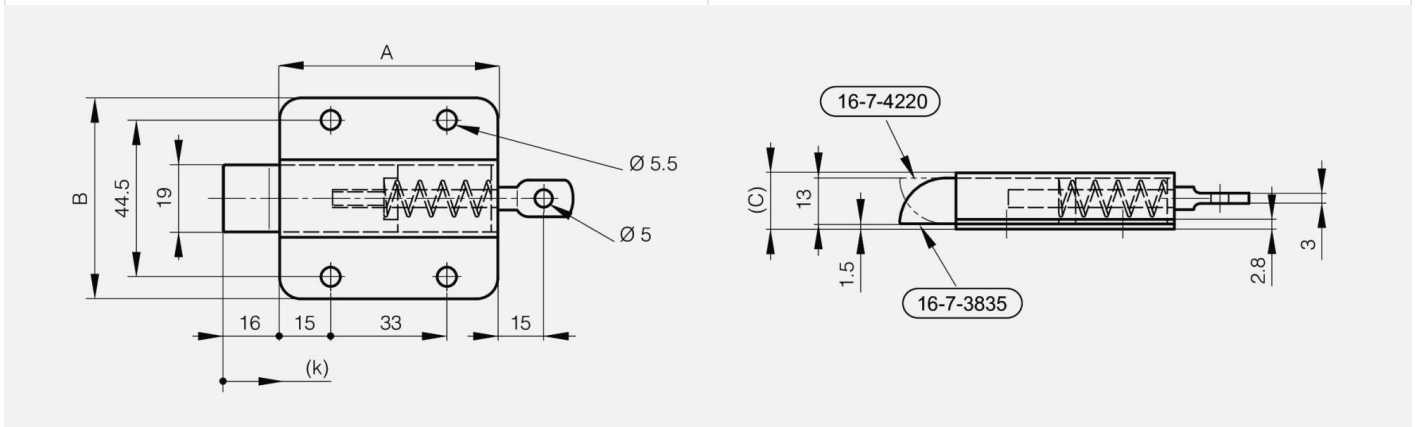

| | |
|----------|------|
| K | 7 mm |
|----------|------|