



ASYMMETRICAL POLYAMIDE HINGES WITH CARBON FIBER

54-1-3559

Hinges are made of 30% carbon fiber 6.6 PA.
Pin: 303 stainless steel.

A (length)	100 mm
Material	polyamide

Weight (g)	115 g
B (width)	150 mm
C	7.8 mm
E	8.25 mm
D (pin diameter)	7
F (pitch)	48 mm
G (pitch)	75 mm
H	62 mm
Finish	black
r	15 mm

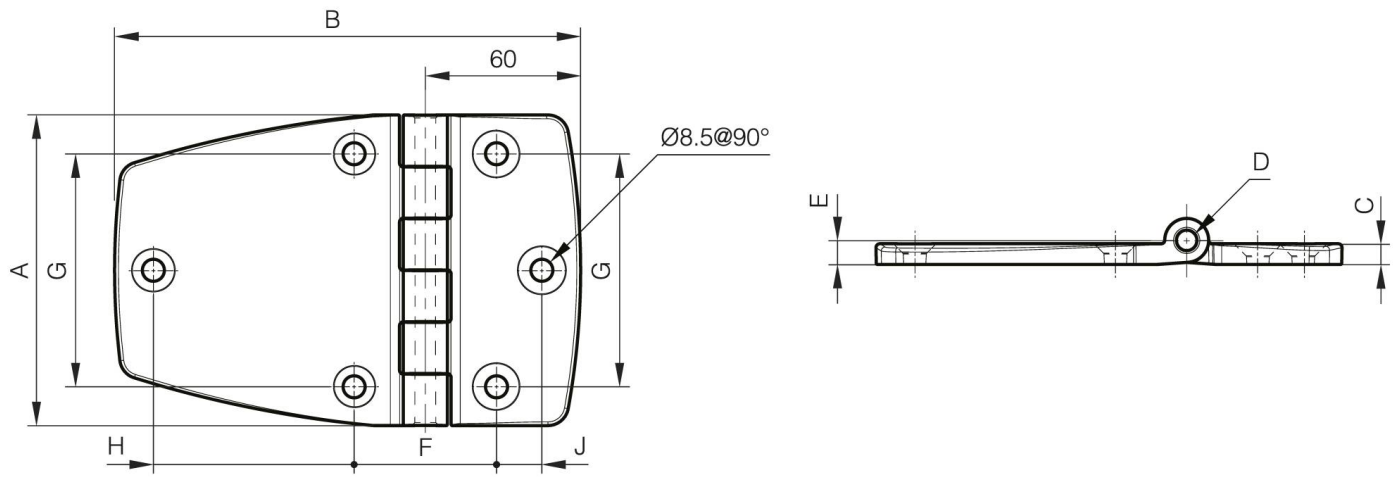

K	50 mm
----------	-------