



ASYMMETRICAL POLYAMIDE HINGES WITH CARBON FIBER

54-1-3562

Hinges are made of 30% carbon fiber 6.6 PA.
Pin: 303 stainless steel.

A (length)	120 mm
Material	polyamide

Weight (g)	168 g
B (width)	180 mm
C	8 mm
E	9.3 mm
D (pin diameter)	8
F (pitch)	55 mm
G (pitch)	90 mm
H	77.5 mm
Finish	black
r	17.5 mm

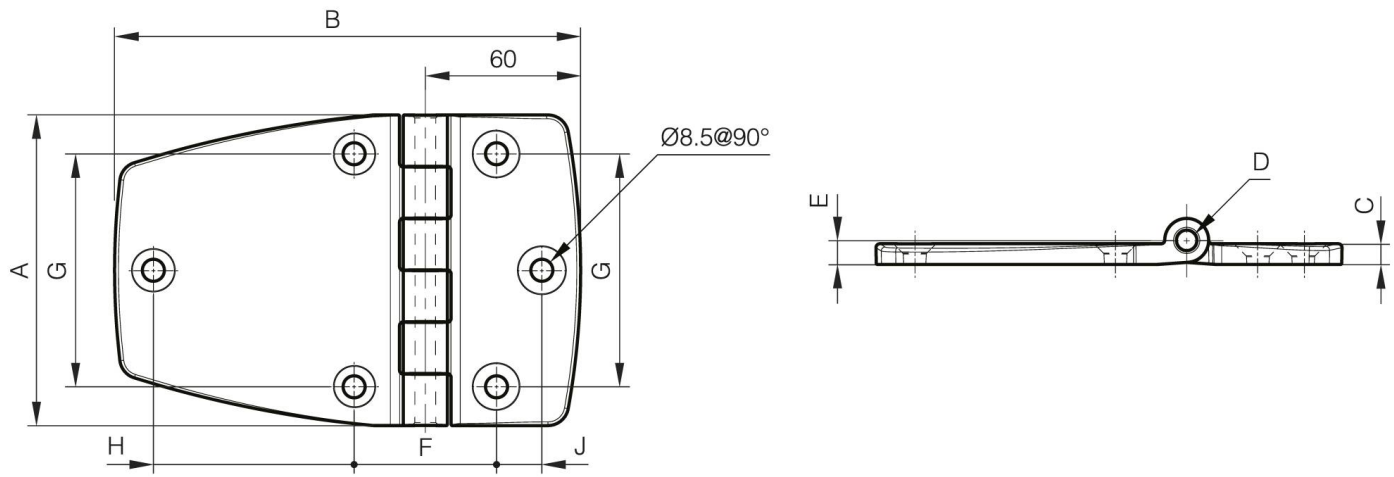

K	60 mm
----------	-------