



FORGED LIFT-OFF HINGES

14-1-3910

With raw brass washer.

A (length)	48 mm
Note	type 2 -Railway Standard
Material	steel

Weight (g)	52 g
B (width)	40 mm
C	3 mm
S	4 mm
E	4 mm
D (pin diameter)	4
F (pitch)	32 mm
G (pitch)	8 mm
Finish	raw

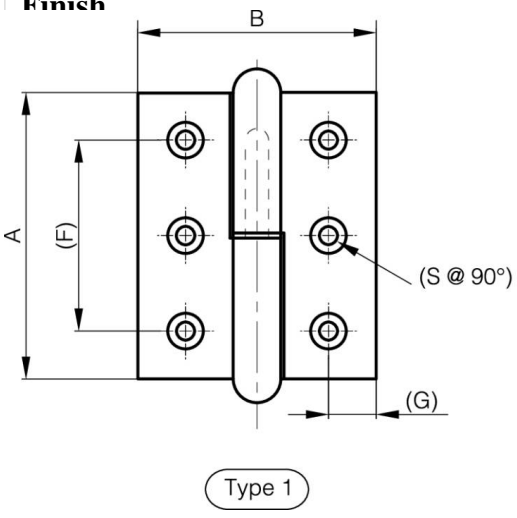

Type 1

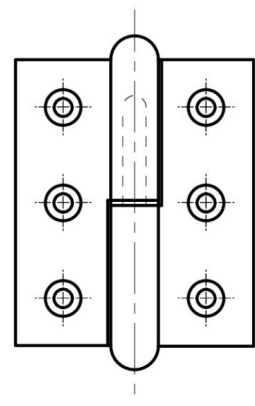

Type 2

