



FORGED LIFT-OFF HINGES

14-1-3913

With raw brass washer.

A (length)	72 mm
Note	type 1 - Railway standard
Material	steel

Weight (g)	156 g
B (width)	60 mm
C	4 mm
S	6.5 mm
E	6 mm
D (pin diameter)	6
F (pitch)	48 mm
G (pitch)	12 mm
Finish	raw

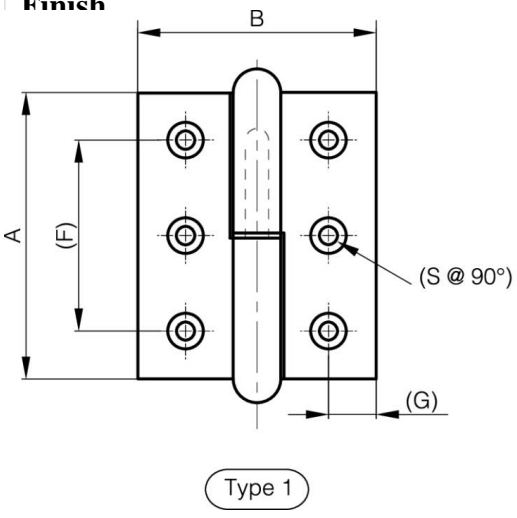

Type 1

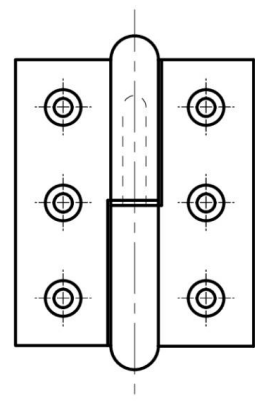

Type 2

