



FORGED LIFT-OFF HINGES

14-1-3916

With raw brass washer.

A (length)	84 mm
Note	type 2 - Railway standard
Material	steel

Weight (g)	245 g
B (width)	70 mm
C	4.5 mm
S	7.5 mm
E	7 mm
D (pin diameter)	7
F (pitch)	56 mm
G (pitch)	14 mm
Finish	raw

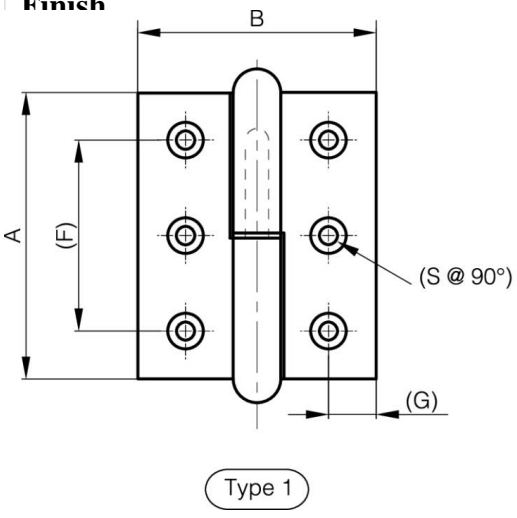

Type 1

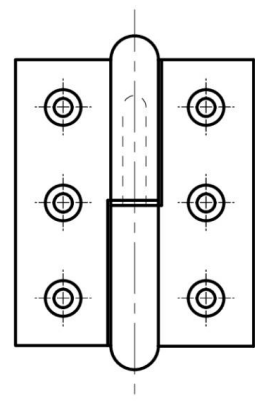

Type 2

