



## FORGED LIFT-OFF HINGES

14-1-3917

With raw brass washer.

<b>A (length)</b>	96 mm
<b>Note</b>	type 1 - Railway standard
<b>Material</b>	steel

<b>Weight (g)</b>	360 g
<b>B (width)</b>	80 mm
<b>C</b>	5 mm
<b>S</b>	8.5 mm
<b>E</b>	8 mm
<b>D (pin diameter)</b>	8
<b>F (pitch)</b>	66 mm
<b>G (pitch)</b>	16 mm
<b>Finish</b>	raw

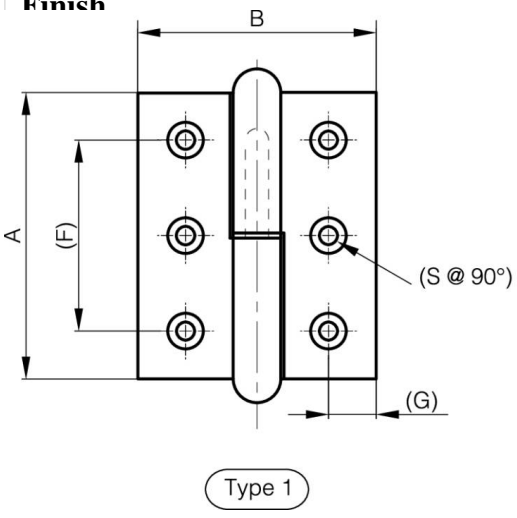

Type 1

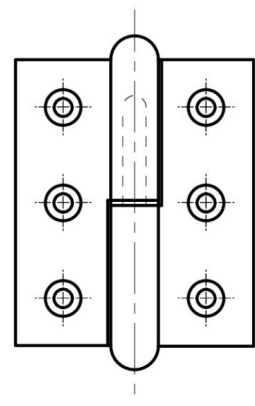

Type 2

