



FORGED LIFT-OFF HINGES

14-1-3930

With raw brass washer.

A (length)	96 mm
Note	type 1
Material	stainless steel

Weight (g)	399 g
B (width)	80 mm
C	5 mm
S	8.5 mm
E	8 mm
D (pin diameter)	8
F (pitch)	66 mm
G (pitch)	16 mm
Finish	raw

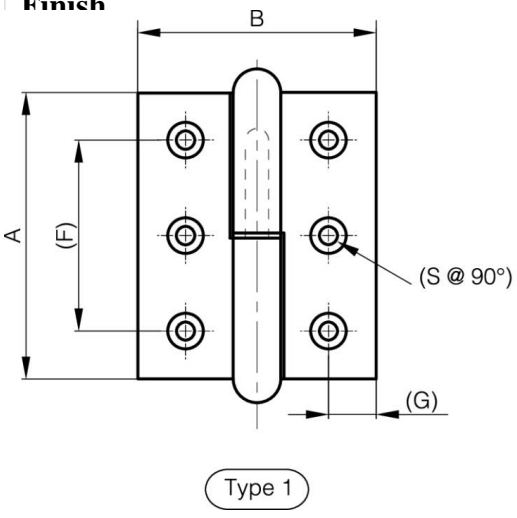

Type 1

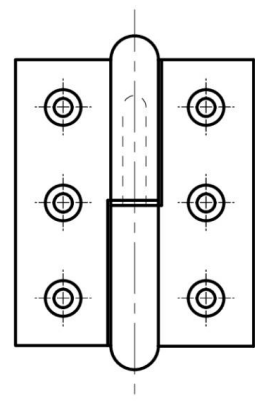

Type 2

