



## **CERNIERE SFILABILI IN ALLUMINIO 100 X 100 MM**

**14-7-3628**

Perno in acciaio zincato. Boccia in nylon.

<b>A</b>	100 mm
<b>Nota</b>	tipo 1

<b>Materiale</b>	alluminio
<b>Peso (g)</b>	106 g
<b>B</b>	100 mm
<b>C</b>	4 mm
<b>S (diamètre trou)</b>	6 mm
<b>D</b>	9
<b>Finitura</b>	argento anodizzato

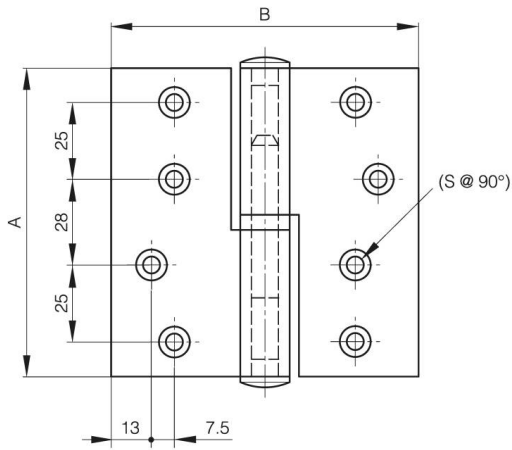

14-7-3628

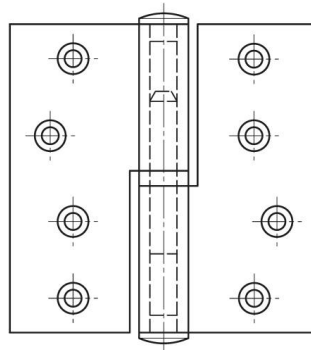

14-7-3629

