



## **CERNIERE DI APERTURA A MOLLA LUNGHE 180 MM**

**71-1-3794**

Forza della molla di apertura: M(0°): 1,7 Nm / M(90°): 1,1 Nm / M(180°): 0,56 Nm Molla in acciaio inossidabile.

<b>A</b>	180 mm
<b>Nota</b>	forata

<b>Materiale</b>	acciaio inossidabile 304
<b>Peso (g)</b>	124 g
<b>B</b>	40 mm
<b>C</b>	1.5 mm
<b>S (diamètre trou)</b>	4 mm
<b>D</b>	4
<b>F</b>	22.7 mm
<b>G</b>	60 mm
<b>Finitura</b>	naturale

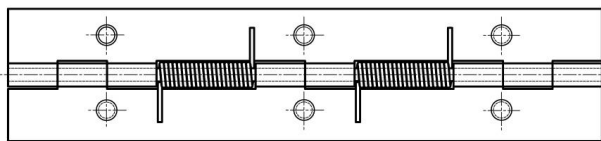
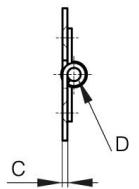
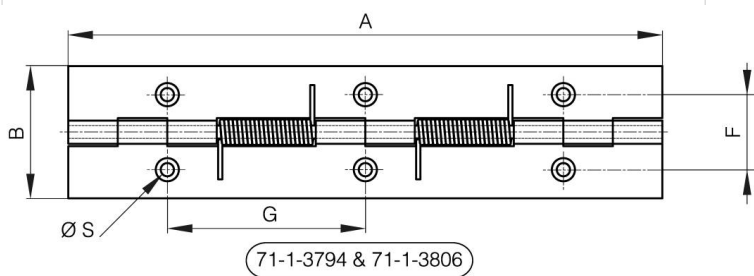

71-1-3881 & 71-1-3890

